

Laid down by a scale of 137,  
 10 Ch. for Inch. — Pine 3X om

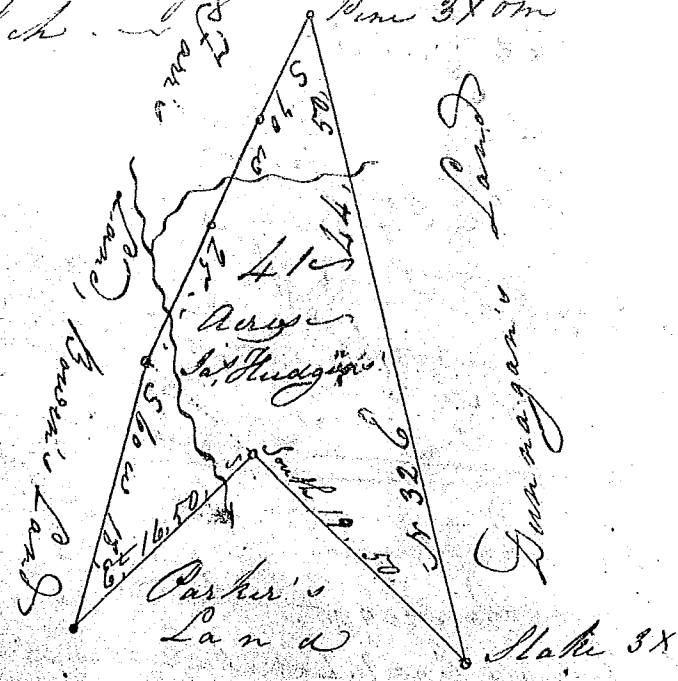

South Carolina

Pursuant to a warrant from  
 John Young Esqr, Comr of Locations for Cherokee  
 District, State aforesaid, dated the 7th day of Feb'y  
 1817. I have admeasured and laid out unto James  
 Hodgen a tract of forty one Acres of Land situate  
 in the District aforesaid, on a small branch  
 of Saluga River, bounded by lines bearing  
 S 70° W, by Farris Land & bow by Bowen's Bowen's Land  
 by line running E. & S. by Bowen Land, by Land  
 Survey for Jett S. E. having & form as the above  
 Plat represents.

Surveyed the 8th of Feb'y 1817  
 J. C. Ausler Ds

Recorded the 20th day of Feb'y 1817. by  
 John Young C. L.